

HJ-320 Step counter Walking style

HJ-320-APW
5338790-4A

INTRODUCTION

Thank you for purchasing the OMRON HJ-320 Step counter.

This Step counter features advanced 3D Smart Sensor technology - so it knows exactly when you're taking a step. It's more accurate than other step counters which use a simple pendulum design. Use this in your pocket, bag or on your hip for added convenience. Use this unit everyday to monitor your fitness achievements! Your Step counter comes with the following components:

- Step counter
- Battery (CR2032 installed)
- Holder
- Instruction Manual

Please read this instruction manual thoroughly before using the unit. Please keep for future reference.

IMPORTANT SAFETY INFORMATION

To assure the correct use of the product basic safety measures should always be followed including the warnings and cautions listed in this instruction manual.

SAFETY SYMBOLS USED IN THIS INSTRUCTION MANUAL

	Indicates a potentially hazardous situation which, if not avoided, could result in death or serious injury.
	Indicates a potentially hazardous situation which, if not avoided, may result in minor or moderate injury to the user or patient or damage to the equipment or other property.

OPERATING THE DEVICE

- Contact your physician or healthcare provider before beginning a weight reduction or exercise program.
- Keep the unit out of the reach of young children. The unit contains small pieces that may be swallowed. Immediately contact your physician if any piece is swallowed.
- Please use caution when wearing the unit around your neck so as to avoid possible strangulation. Do not place the unit around the neck of children.
- If battery fluid gets in your eyes, immediately rinse with plenty of clean water. Contact a physician immediately.
- Read all information in the instruction manual and any other literature included in the box before using the unit. Operate the unit only as intended. Do not use for any other purpose.
- If battery fluid gets on your skin or clothing, immediately rinse with plenty of clean water.
- Do not insert the battery with the polarities in the wrong direction.
- Do not throw the battery into fire. The battery may explode.
- Dispose of the device, battery, and components according to applicable local regulations. Unlawful disposal may cause environmental pollution.

CARE AND MAINTENANCE

- Do not disassemble or modify the unit. Changes or modifications not approved by Omron Healthcare will void the user warranty.
- Do not subject the unit to strong shocks, such as dropping the unit on the ground.
- Do not submerge the unit or any of the components in water.

KNOW YOUR UNIT

Front of unit

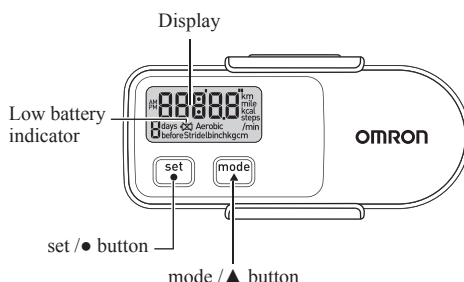

NOTE:

Remove the protective film from the face of the display.

Back of the main unit

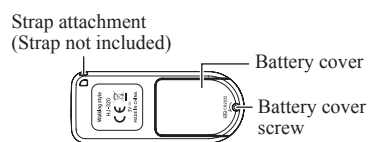

Components

Holder

Attach/remove the holder as illustrated below.

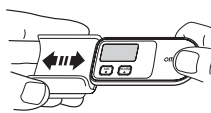

NOTE:

When attaching the holder, do not grip it strongly at the top and bottom.



STRIDE LENGTH MEASUREMENT

Measure your stride length before setting the step counter.

How to measure your stride length

- Walk 10 steps with your normal stride as illustrated below.

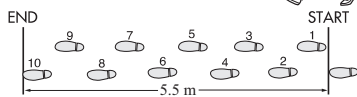

- Measure the distance from START to END in meters.
- Calculate your stride length by dividing the total distance by 10.

Example:
Total distance = 5.5 m
 $5.5 \div 10 = 0.55 \text{ m (55 cm)}$

SETTINGS

The unit comes with the battery installed. When you use the unit for the first time, follow the steps below. For setting range details refer to "SPECIFICATIONS".

NOTE:

If the initial settings are not correct, the measurement results may not be accurate.

- Press and hold or . After the following display, "inch" and "cm" flash on the display.

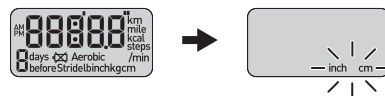

- Setting the stride length unit.

A) Press to select the mode.

B) Press to confirm the setting.

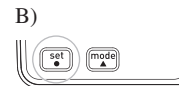
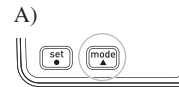

- To set the distance unit, repeat steps A) and B) in step 2 above.
- To set the time display, repeat steps A) and B) in step 2 above.
- Setting the stride length.

A) Press to select the desired value for a setting.

- Press to advance one.
- Hold down to advance rapidly.

B) Press to confirm the setting.

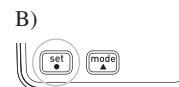
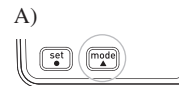

- To set the hour, repeat steps A) and B) in step 5 above.
- To set the minute, repeat steps A) and B) in step 5 above.

All the settings are completed.

Adjust the settings

- Press and hold . "inch" or "cm" flash on the display.
- Follow the procedure from step 2 of "SETTINGS".

USING THE UNIT

The unit accurately counts in a pocket, bag or anywhere you want to put it. The unit may be placed in the upper front pocket of your clothing, in the front pocket of your pants, in a bag, or attached to your belt or pants, or hang it from your neck.

- Simply bring the unit with you wherever you go.

NOTE:

In order to avoid counting steps that are not part of a walk, the unit does not display the step count for the first 4 seconds of walking. If you continue walking for more than 4 seconds, it displays the step count for the first 4 seconds and then continues to count.

- Press to read the data.

The unit may not count steps correctly in the following conditions:

- The unit moves irregularly.
 - When the unit is placed in a bag and a bag moves irregularly.
 - When the unit swings from your belt, the top of your pants or a bag.
- Walking at an inconsistent pace.
 - When you shuffle or wear sandals.
 - Starting and stopping or other forms of inconsistent walking.
- Up and down movement.
 - Standing up and/or sitting down movement.
 - Playing sports other than walking.
 - Ascending or descending movement on stairs or on a steep slope.



- Vibrations from a moving vehicle.
 - Such as riding a bicycle, automobile, train or bus.
- Walking extremely slowly.

READING THE CURRENT DISPLAY

Press to change the display.

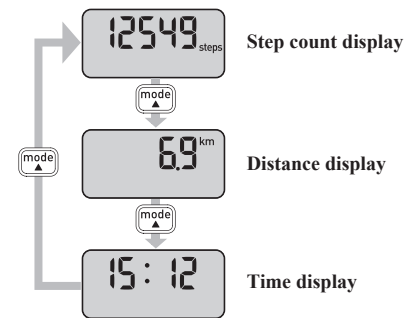

The battery saving mode

After 5 minutes with no button being pressed, the display will automatically turn off. However, the unit continues to count steps. This mode extends the battery life. Press or to activate the display again.

CLEAR THE CURRENT STEPS

- Press and hold . "Clr" flashes on the display.
- Press twice, the current steps will be cleared.

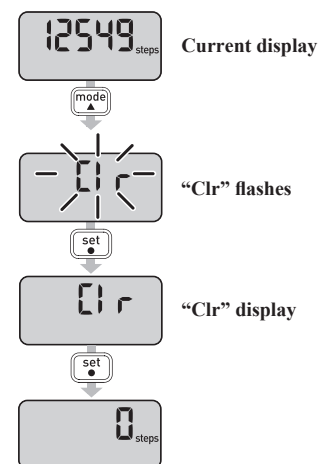

Then the unit will count steps from "0 steps".

BATTERY LIFE

If the symbol blinks or appears on the display, replace the battery with a new (CR2032) battery. If the battery is removed, the settings and all measurement values will be deleted. Please reset the settings (refer to "SETTINGS").

NOTES:

- If you want to keep any of the measurement values, make a note of them before removing the battery.
- The supplied battery is for initial use. The battery life may be shorter.

BATTERY REPLACEMENT

1. Loosen the screw of the battery cover on the back of the unit. Remove the battery cover by pulling it off in the direction of the arrow.

Use a small screwdriver to loosen the screw on the battery cover.

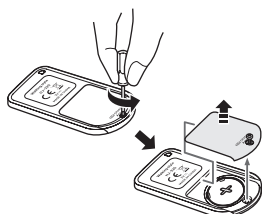

2. Remove the battery with a toothpick.



NOTE:

Do not use a pair of metal tweezers or any metal object such as a small screwdriver.

CAUTION

Dispose of the device, battery, and components according to applicable local regulations. Unlawful disposal may cause environmental pollution.

CAUTION

Do not throw the battery into fire. The battery may explode.

3. Insert the battery (CR2032) with the positive (+) side face up.

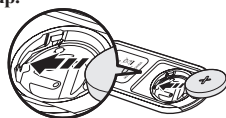

4. Replace the battery cover by sliding the catch in first, then tighten the screw.

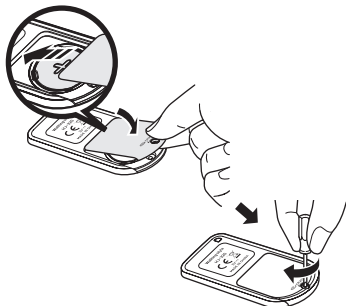

CARE AND MAINTENANCE

To keep the unit in the best condition and protect the unit from damage follow the directions listed below:

CAUTION

Do not disassemble or modify the unit. Changes or modifications not approved by OMRON Healthcare will void the user warranty.

Clean the unit with a soft dry cloth.

Do not use any abrasive or volatile cleaners.



Do not immerse the unit or any of the components in water.

The unit is not waterproof. Do not wash it or touch it with wet hands. Be careful that water does not get into the unit.

Store the unit in a safe and dry location.

Avoid the unit being exposed to direct sunlight, high temperatures, high humidity, water and/or dust.



Do not subject the unit to strong shock, drop, or step on it.

Replace a worn battery with a new one immediately.

Remove the battery if the unit will not be used for three months or longer.

Use of the unit must be consistent with the instructions provided in this manual.

TROUBLESHOOTING TIPS

Problem	Probable Cause	How to Correct
The low battery indicator blinks or appears continuously.	The battery is low or worn.	Replace the battery with a new one (CR2032), refer to "BATTERY REPLACEMENT".
Nothing is displayed.	Battery saving mode active.	Press either of  , refer to "About the battery saving mode (sleep mode)" in "READING THE CURRENT DISPLAY".
	The polarities of the battery (+ and -) are aligned in the wrong directions.	Insert the battery in correct alignment, refer to "BATTERY REPLACEMENT".
	The battery is worn.	Replace the battery with a new one (CR2032), refer to "BATTERY REPLACEMENT".
The displayed values are incorrect.	The unit is positioned incorrectly.	Refer to "The unit may not count steps correctly in the following conditions:" in "USING THE UNIT".
	Irregular movement. Inconsistent pace. Up and down movement.	
	The set values are wrong.	Check the settings, refer to "SETTINGS".
The display is unusual or the buttons do not operate normally.		Replace the battery with a new one (CR2032), refer to "BATTERY REPLACEMENT".
	Device error.	Reinstall the battery, refer to "BATTERY REPLACEMENT".

NOTE:

If a malfunction has occurred and you need to repair your unit, all settings and measurement results are deleted. We recommend that you record measurement results.

SPECIFICATIONS

Product Name:	Walking style
Type:	HJ-320
Power Supply:	3VDC (1 lithium battery CR2032)
Measurement Range:	Steps: 0 to 99,999 steps
	Distance: 0.0 to 5,999.9 km / 0.0 to 3,725.9 miles
	Time: 0:00 to 23:59 / 12:00AM to 11:59PM
Setting Range:	Time: 0:00 to 23:59 / 12:00AM to 11:59PM
	Stride length: 30 to 120 cm (in increments of 1 cm) / 12" to 48" (in increments of 1 inch)
Operating Temperature/Humidity:	-10°C to +40°C (14°F to 104°F) / 30% to 85% RH
Battery Life:	Approx. 6 months* (When used for 12 hours a day) NOTE: The supplied battery is for initial use. This battery can run out within 6 months.
External Dimensions:	Approx. 75.0(W) × 31.0(H) × 8.0(D) mm
Weight:	Approx. 20 g (battery included)
Contents:	Step counter, Holder, Battery (CR2032 installed), and Instruction manual

- Specifications are subject to change without notice. This OMRON product is produced under the strict quality system of OMRON HEALTHCARE Co., Ltd. Japan.

* Based on OMRON test using new battery.



Correct Disposal of This Product (Waste Electrical & Electronic Equipment)



This marking shown on the product or its literature, indicates that it should not be disposed of, with other household wastes at the end of its working life. To prevent possible harm to the environment or human health from uncontrolled waste disposal, please separate this from other types of wastes and recycle it responsibly to promote the sustainable reuse of material resources. Household users should contact either the retailer where they purchased this product, or their local government office, for details of where and how they can take this item for environmentally safe recycling. Business users should contact their supplier and check the terms and conditions of the purchase contract. This product should not be mixed with other commercial wastes for disposal. This product does not contain any hazardous substances. Disposal of used batteries should be carried out in accordance with the national regulations for the disposal of batteries.

	OMRON HEALTHCARE Co., Ltd. 53, Kunotsubo, Terado-cho, Muko, Kyoto, 617-0002 JAPAN
	OMRON HEALTHCARE EUROPE B.V. Scorpius 33, 2132 LR Hoofddorp, THE NETHERLANDS
Asia Pacific HQ	OMRON HEALTHCARE SINGAPORE PTE LTD. 438A Alexandra Road, #05-05/08, Alexandra Technopark Singapore 119967 www.omron-healthcare.com.sg
Production Facility	OMRON (DALIAN) CO., LTD. Dalian, CHINA